

These fittings are used in the adaptation of parts to an application in order to work together as a unit. They are commonly made by using a female (inner) to a male (outer) thread combination on each part.

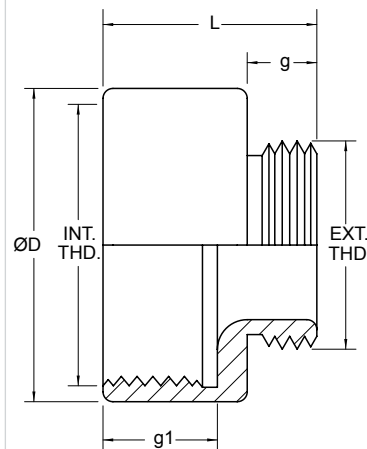

SIZE	SIZE	MATERIAL
M32	N06	MA
MALE THREAD TYPE	FEMALE THREAD TYPE	
M		RAW ALUMINUM
MA		NICKEL PLATED ALUMINUM
MAB		BLACK ANODIZED ALUMINUM
B		BRASS METAL
MB		NICKEL PLATED BRASS
MBR		CHROME PLATED BRASS
N		NYLON
SS		STAINLESS STEEL



Specifications are subject to change without notice

FROM METRIC TO NPT THREAD

Order Number	EXT. THD.	INT. THD.	Ø D		L		g		g1	
			mm	in	mm	in	mm	in	mm	in
M16N01MA	M16x1.5	NPT 3/8"	20.0	0.79	25.0	0.98	7.0	0.28	16.0	0.63
M16N02MA	M16x1.5	NPT 1/2"	24.0	0.94	25.0	0.98	7.0	0.28	16.0	0.63
M20N01MA	M20x1.5	NPT 3/8"	22.0	0.87	25.0	0.98	7.0	0.28	16.0	0.63
M20N02MA	M20x1.5	NPT 1/2"	24.0	0.94	24.5	0.96	6.5	0.26	16.0	0.63
M22N02MA	M22x1.5	NPT 1/2"	24.0	0.94	25.0	0.98	7.0	0.28	16.0	0.63
M16N04MA	M16x1.5	NPT 3/4"	30.0	1.18	25.0	0.98	7.0	0.28	16.0	0.63
M20N04MA	M20x1.5	NPT 3/4"	30.0	1.18	25.0	0.98	7.0	0.28	16.0	0.63
M22N04MA	M22x1.5	NPT 3/4"	30.0	1.18	25.0	0.98	7.0	0.28	16.0	0.63
M25N04MA	M25x1.5	NPT 3/4"	30.0	1.18	25.0	0.98	7.0	0.28	16.0	0.63
M16N06MA	M16x1.5	NPT 1"	36.0	1.42	26.5	1.04	7.0	0.28	18.0	0.71
M20N06MA	M20x1.5	NPT 1"	36.0	1.42	26.5	1.04	7.0	0.28	18.0	0.71
M22N06MA	M22x1.5	NPT 1"	36.0	1.42	26.5	1.04	7.0	0.28	18.0	0.71
M25N06MA	M25x1.5	NPT 1"	36.0	1.42	26.5	1.04	7.0	0.28	18.0	0.71
M32N06MA	M32x1.5	NPT 1"	36.0	1.42	26.5	1.04	7.0	0.28	18.0	0.71
M16N07MA	M16x1.5	NPT 1 1/4"	44.0	1.73	28.0	1.10	7.0	0.28	19.0	0.75
M20N07MA	M20x1.5	NPT 1 1/4"	44.0	1.73	28.0	1.10	7.0	0.28	19.0	0.75
M22N07MA	M22x1.5	NPT 1 1/4"	44.0	1.73	28.0	1.10	7.0	0.28	19.0	0.75
M25N07MA	M25x1.5	NPT 1 1/4"	44.0	1.73	28.0	1.10	7.0	0.28	19.0	0.75
M32N07MA	M32x1.5	NPT 1 1/4"	46.0	1.81	29.0	1.14	8.0	0.31	19.0	0.75
M40N07MA	M40x1.5	NPT 1 1/4"	44.0	1.73	29.0	1.14	8.0	0.31	19.0	0.75
M16N08MA	M16x1.5	NPT 1 1/2"	50.0	1.97	30.0	1.18	7.0	0.28	20.0	0.79
M20N08MA	M20x1.5	NPT 1 1/2"	50.0	1.97	30.0	1.18	7.0	0.28	20.0	0.79
M22N08MA	M22x1.5	NPT 1 1/2"	50.0	1.97	30.0	1.18	7.0	0.28	20.0	0.79
M25N08MA	M25x1.5	NPT 1 1/2"	50.0	1.97	30.0	1.18	7.0	0.28	20.0	0.79
M32N08MA	M32x1.5	NPT 1 1/2"	50.0	1.97	30.0	1.18	8.0	0.31	20.0	0.79
M40N08MA	M40x1.5	NPT 1 1/2"	50.0	1.97	30.0	1.18	8.0	0.31	20.0	0.79
M16N09MA	M16x1.5	NPT 2"	63.0	2.48	30.0	1.18	7.0	0.28	20.0	0.79
M20N09MA	M20x1.5	NPT 2"	63.0	2.48	30.0	1.18	7.0	0.28	20.0	0.79
M22N09MA	M22x1.5	NPT 2"	63.0	2.48	30.0	1.18	7.0	0.28	20.0	0.79
M25N09MA	M25x1.5	NPT 2"	63.0	2.48	30.0	1.18	7.0	0.28	20.0	0.79
M32N09MA	M32x1.5	NPT 2"	63.0	2.48	30.0	1.18	8.0	0.31	20.0	0.79
M40N09MA	M40x1.5	NPT 2"	63.0	2.48	30.0	1.18	8.0	0.31	20.0	0.79
M52N09MA	M52x1.5	NPT 2"	63.0	2.48	31.0	1.22	9.0	0.35	20.0	0.79